

INSERTION LEVEL SWITCHES

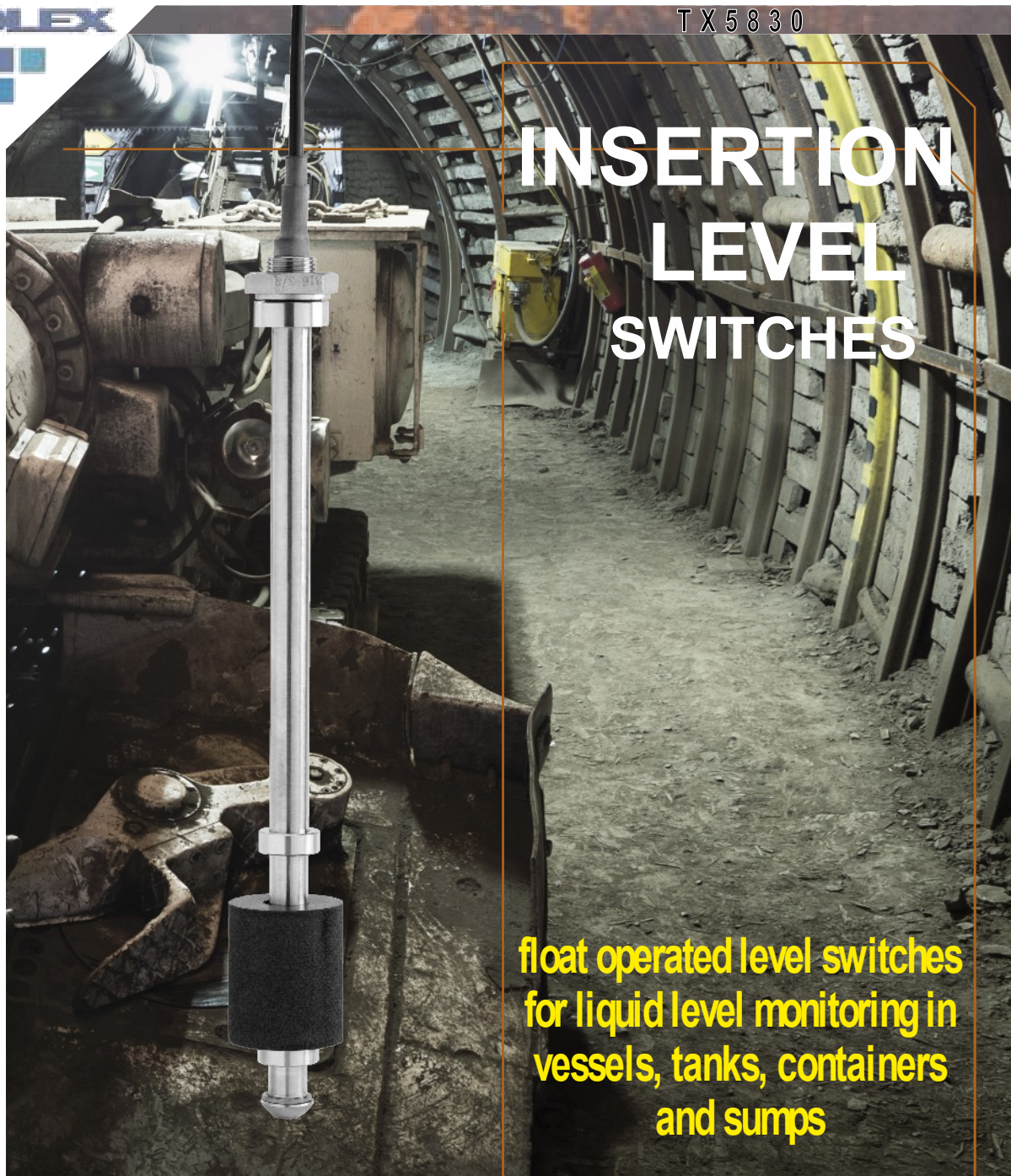

float operated level switches for liquid level monitoring in vessels, tanks, containers and sumps

- TUNNELS
-
- MINING
-
- RESERVOIRS
-
- PUMPING INDUSTRY

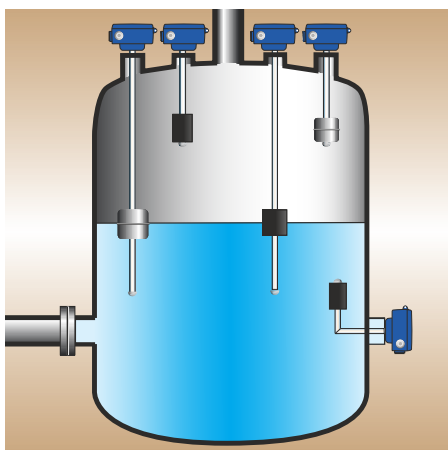

versatile

- Top-of-tank insertion with a choice of mounting options for fuel tanks, storage containers, power packs, cooling systems, process vessels and food processing.
- Stainless steel construction, available in two sizes for medium and heavy duty applications.
- Up to five output contacts.



standard level switches...

with a choice of **FLEXIBLE CABLE CONNECTION OR TERMINAL HOUSING**

12mmØ CONTACT TUBE up to 2000 metres long

...simple
safety
monitoring

TX5831
G 3/8" BUSH MOUNTING
(Supplied with fixing nut)



Flexible Cable

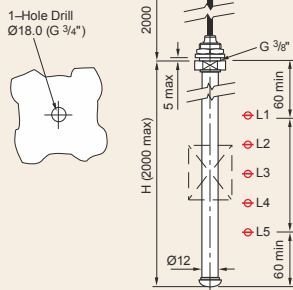

Terminal Housing

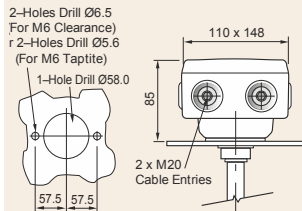

Recommended Floats

- 37mm Ø Phenolic Foam (32)
- 55mm Ø Stainless Steel (34)

TX5832
G1 1/2" BUSH MOUNTING



Flexible Cable

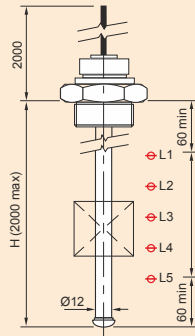

Terminal Housing

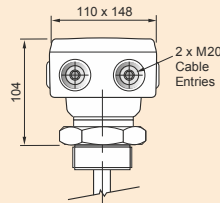

Recommended Floats

- 37mm Ø Phenolic Foam (32)

TX5833
G2" BUSH MOUNTING



Flexible Cable

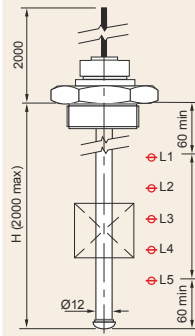

Terminal Housing

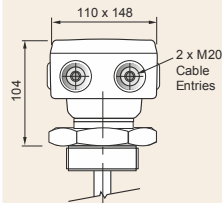

Recommended Floats

- 37mm Ø Phenolic Foam (32)
- 55mm Ø Stainless Steel (34)

TX5834
BS4504 FLANGE MOUNTING
(Other Flange Formats Available)



Flexible Cable

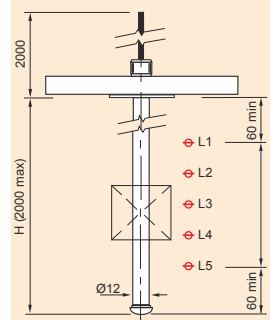

Terminal Housing

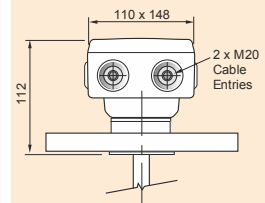

Recommended Floats

- 37mm Ø Phenolic Foam (32)
- 55mm Ø Stainless Steel (34)

ALL DIMENSIONS IN MM



...simple
safety
monitoring

technical details...

Temperature Limits:	-10...80°C with phenolic foam float.	-10...150°C with stainless steel float.
Maximum Static Pressure:	5 bar with phenolic foam float.	20 bar with stainless steel float.
Switching Point Accuracy:	±3mm.	
Mounting Attitude:	Vertical ±30°C.	
Protection Classification:	Dust and waterproof to IP66.	
Body Material:	Stainless steel 316.	
Terminal Housing Material:	Stainless steel filled Polyamide 6.	
Electrical Connections:	Flexible Cable:	2 to 6 core flexible PVC cable, 0.75mm ² x 2m.
	Terminal Housing:	4mm barrier terminals.
Maximum Number of Contacts:	5 (sealed magnetic reed).	
Minimum Spacing Between Adjacent Contacts:	65mm.	
Contact Operation:	Close on RISING float or Close on FALLING float.	

electrical details...

Magnetic Reed Contacts: 240V ac, 0.5 Amp, 25 Watts.

N.B. Contact protection is recommended to ensure that these instantaneous ratings are not exceeded during peak in-rush or surge conditions.

Our Technical Applications Department will be pleased to assist with circuit applications.

connections...

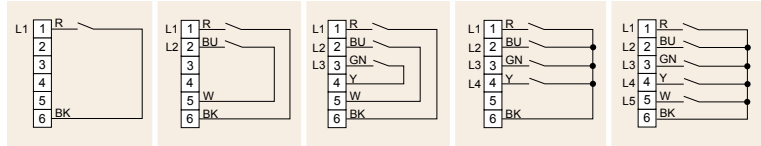

floats...

TX5801

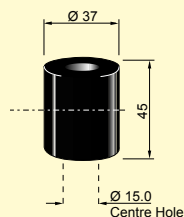

Material: Rigid Phenolic Foam.

Maximum Temperature: 80°C.

Maximum Pressure: 5 bar.

Specific Gravity: 0.4.

- Rigid, closed cell, polyester foam for general purpose applications.
- Excellent resistance to oils, seawater, acids, alkalis and solvents.

TX5802

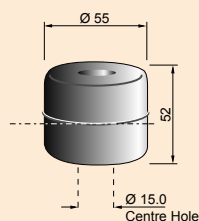

Material: Stainless Steel 316.

Maximum Temperature: 150°C.

Maximum Pressure: 20 bar.

Specific Gravity: 0.45.

- Electron beam welded and pressure tested.
- High impact strength, high temperature rating and high pressure tolerance with excellent chemical resistance.
- Food industry and petrochemical applications.



...simple
safety
monitoring

order reference...

PLEASE PHOTOCOPIY THIS SECTION AND TICK YOUR REQUIREMENTS

<p>TX5831 INSERTION LEVEL SWITCH</p>	<p>12mmØ CONTACT TUBE G3/8" BUSH MOUNTING</p>	
<p>TX5832 INSERTION LEVEL SWITCH</p>	<p>12mmØ CONTACT TUBE G1 1/2" BUSH MOUNTING</p>	
<p>TX5833 INSERTION LEVEL SWITCH</p>	<p>12mmØ CONTACT TUBE G2" BUSH MOUNTING</p>	
<p>TX5834 INSERTION LEVEL SWITCH</p>	<p>BS4504 FLANGE MOUNTING (Please specify alternative flange format required)</p>	

ELECTRICAL DETAILS	Flexible Cable	.11
	Stainless Steel filled Polyamide 6	.12
TYPE OF FLOAT	Rigid Phenolic Foam Ø37mm	.32
	Stainless Steel Ø55mm	.34
TYPE OF LIQUID (or specific gravity of liquid)		

CONTACT FORMAT	Switching Level	Open on Rising	Close on Rising
<p>Minimum spacing between adjacent contacts: 65mm</p>	L1.....mm		
	L2.....mm		
	L3.....mm		
	L4.....mm		
	L5.....mm		
	<p>H.....mm (Standard height H= L1+60mm). Please specify preferred height if greater than L1+60mm.</p>		

CUSTOMER:
CONTACT:
ORDER/ENQ REF:
DATE:

TROLEX LIMITED
NEWBY ROAD, HAZEL GROVE, STOCKPORT,
CHESHIRE SK7 5DY, UK
+44 (0)161 483 1435
sales@trolex.com
www.trolex.com